

CUSTOM OVERSIZED BILLET UPPER MARKER LIGHT COVERS FOR THE HUMMER H2

IMPORTANT: Read And Understand All Instructions Before Installation • QUESTIONS? CALL 1-800-982-1180

These instructions apply to both rear and front upper marker lights. Time to install set of three: Approx. 25 Minutes

Tools Needed: Standard and Phillips Screwdriver



STEP 1. Remove factory upper marker light by inserting a small screwdriver into the side of the marker light where the relief area is. (See Photo 1)

Note: When you push into this area of the side marker light you will be pushing into a spring clip, that when pushed into properly will allow the marker light to be released very easily.



STEP 2. Carefully pull the light out to get some slack in the wiring. (See Photo 2)



STEP 3. Remove the light bulb plug by turning the plug counter clockwise to release the plug from the upper marker light lens. (See Photo 3)



STEP 4. Insert the two speed nuts (provided) into the areas were the two mounting holes are. (See Photo 4)



STEP 5. Insert the light bulb plug into the new billet marker light bezel. Then pull some slack of the wiring out through the billet bezel and place back into position on the vehicle. (See Photos 5A and 5B)

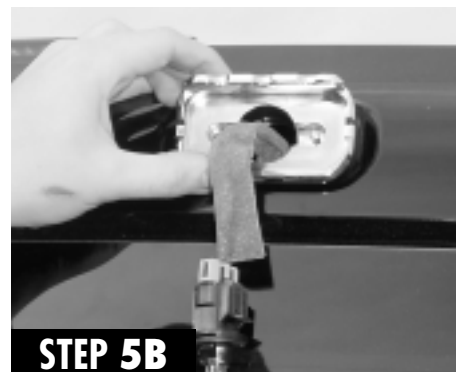



STEP 6A



STEP 6B



STEP 7

STEP 6. Insert and alternate tightening the two Phillips head screws (provided) into the two mounting holes of the billet bezel. Note: Make sure the screws tighten into the previously installed speed nuts. Additional Note: The screws may go into the speed nuts on a slight angle at the beginning and straighten out when they completely tighten down. (See Photos 6A and 6B)

STEP 7. Reinsert the light bulb plug back into the factory marker light bezel. (See Photo 7)



STEP 8A



STEP 8B



STEP 8C

STEP 8. Line up the factory marker light with the new billet bezel. Make sure to position the marker light on an angle so the solid plastic clip gets positioned into one side of the slot in the billet bezel first. Then align the other

clip with the spring clip on it, into the slot on the other side of the billet bezel, then push and make sure the marker light clips and locks into position. (See Photos 8A, 8B and 8C)



REALWHEELS COVER COMPANY, INC.

3940 Tannahill Drive • Gurnee, IL 60031

847-662-7722 • Fax 847-662-7744 • www.realwheelsacc.com

info@realwheelsacc.com • toll-free 1-800-982-1180

Hummer and H2 are registered trademarks of General Motors Corporation and are used for identification purposes only. RealWheels Cover Company, Inc. and its products are not affiliated with General Motors Corporation products.